

REFERENCE NUMBER:

S73/2017/0902



SITE:

LAND AT PLOTS 1, 2 & 3 AND PART OF PLOT 4
LYONS PARK
COUNDON WEDGE

1:1250

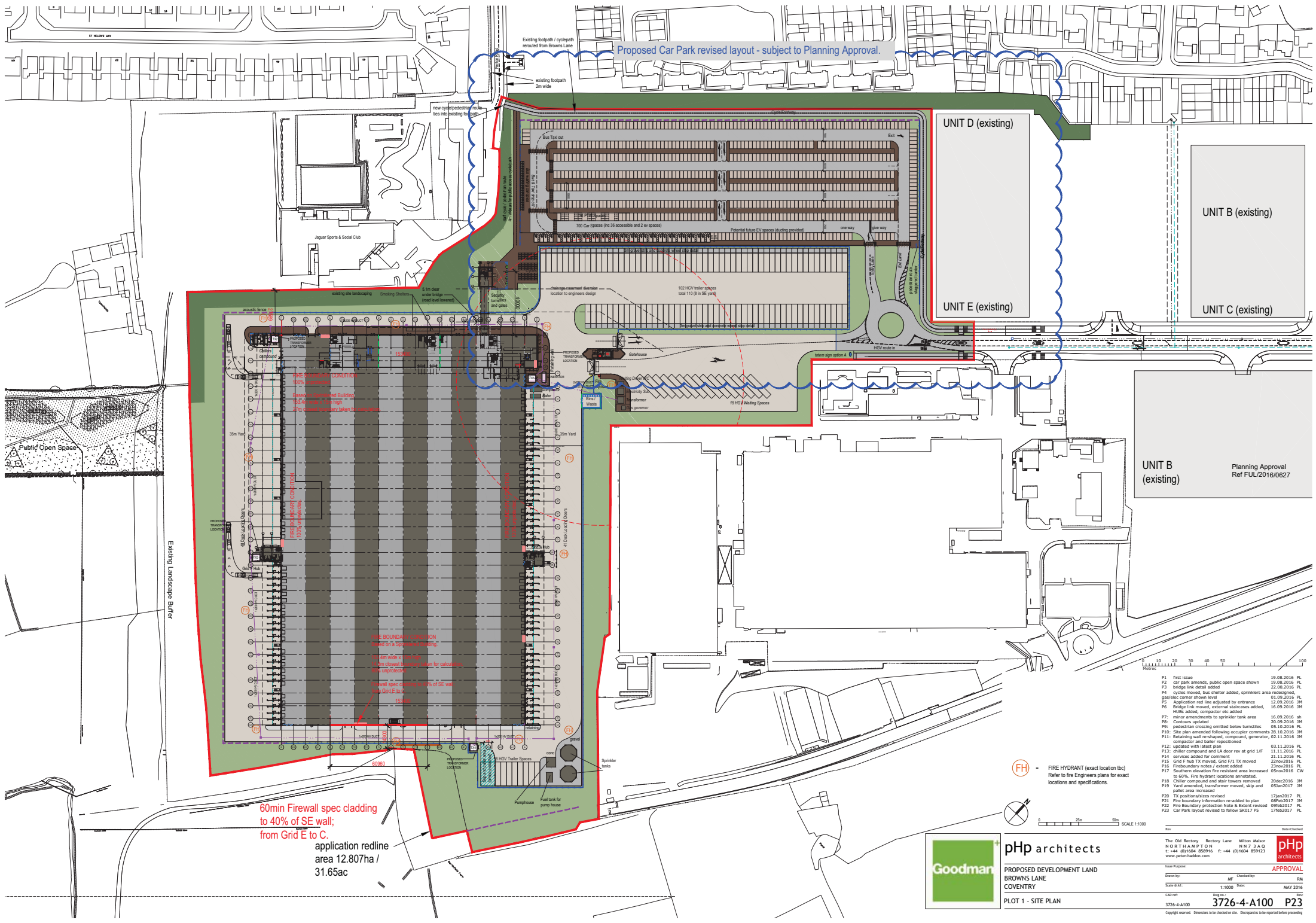

- P1 first issue 19.08.2016 PL
- P2 car park amend, public open space shown 19.08.2016 PL
- P3 bridge link detail added 22.08.2016 PL
- P4 cycle moved, bus shelter added, sprinklers area redesigned, gas/elec corner shown level 03.09.2016 PL
- P5 Application red line adjusted by entrance 12.09.2016 JM
- P6 Bridge link moved, external staircases added, 16.09.2016 JM
- P7 minor amendments to sprinkler tank area 16.09.2016 sh
- P8 Contours updated 20.09.2016 JM
- P9 pedestrian crossing omitted below turnstiles 05.10.2016 PL
- P10 Site plan amended following occupier comments 08.10.2016 JM
- P11 Retaining wall re-shaped, compound, generator, 02.11.2016 JM
- P12 updated with latest plan 03.11.2016 PL
- P13 chiller compound and LA door rev at grid 1/F 11.11.2016 PL
- P14 services added for comment 21.11.2016 PL
- P15 Grid F 1/F TX moved, Grid F 1/F TX moved 23Nov2016 PL
- P16 Fireboundary notes / extent added 23Nov2016 PL
- P17 Southm elevation fire resistant area increased 05Nov2016 CW
- P18 Chiller compound and LA door removed 05Nov2016 CW
- P19 Yard amended, transformer moved, slip and 05Jan2017 JM
- P20 pit area increased 05Jan2017 JM
- P21 TX positions revised 17Jan2017 JM
- P22 Fire boundary information re-added to plan 08Feb2017 JM
- P23 Fire Boundary protection Note & Extent revised 09Feb2017 PL
- P24 Car Park layout revised to follow SK017 P5 17Feb2017 PL

FH = FIRE HYDRANT (exact location loc)
Refer to fire Engineers plans for exact locations and specifications.

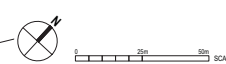

pHp architects

PROPOSED DEVELOPMENT LAND
BROWNS LANE
COVENTRY

PLOT 1 - SITE PLAN

3726-4-A100 P23

APPROVAL

Scale of A1: 1:1000 Date: MAY 2016

3726-4-A100

FIRE PROTECTION NOTES:

- ALL COLUMNS AND BEAMS SUPPORTING FLOOR AND STAIRCASES TO BE PROTECTED TO ACHIEVE 30mins FIRE RESISTANCE.
- ALL STEELWORK SUPPORTING / RESTRAINING COMPARTMENT WALL TO BE PROTECTED TO ACHIEVE 60mins FIRE RESISTANCE.
- ALL FIRE COMPARTMENT WALLS SHOWN DOTTED
 - 60 MINUTE RATED TO BE 30 MINUTE RATED TO BE 60 MINUTE RATED
- *Fire walls to continue up to roof soffit and gaps to be fire stopped.
- **Fire walls to continue up to roof soffit / cavity BARRIER
- *Fire walls to continue up to roof soffit and gaps to be fire stopped. Where shown directly adjacent to fire walls, the fire wall to the corridor / void / cavity barrier within the ceiling void.

Fire Signage Legend

Legend symbols include:

- B02: Fire exit (keep clear)
- B03: Fire exit (keep clear)
- B04: Fire exit (keep clear)
- B05: Fire exit (keep clear)
- B06: Fire exit (keep clear)
- B07: Fire exit (keep clear)
- B08: Fire exit (keep clear)
- B09: Fire exit (keep clear)
- B10: Fire exit (keep clear)
- B11: Fire exit (keep clear)
- B12: Fire exit (keep clear)
- B13: Fire exit (keep clear)
- B14: Fire exit (keep clear)
- B15: Fire exit (keep clear)
- B16: Fire exit (keep clear)
- B17: Fire exit (keep clear)
- B18: Fire exit (keep clear)
- B19: Fire exit (keep clear)
- B20: Fire exit (keep clear)
- B21: Fire exit (keep clear)
- B22: Fire exit (keep clear)
- B23: Fire exit (keep clear)
- B24: Fire exit (keep clear)
- B25: Fire exit (keep clear)
- B26: Fire exit (keep clear)
- B27: Fire exit (keep clear)
- B28: Fire exit (keep clear)
- B29: Fire exit (keep clear)
- B30: Fire exit (keep clear)
- B31: Fire exit (keep clear)
- B32: Fire exit (keep clear)
- B33: Fire exit (keep clear)
- B34: Fire exit (keep clear)
- B35: Fire exit (keep clear)
- B36: Fire exit (keep clear)
- B37: Fire exit (keep clear)
- B38: Fire exit (keep clear)
- B39: Fire exit (keep clear)
- B40: Fire exit (keep clear)
- B41: Fire exit (keep clear)
- B42: Fire exit (keep clear)
- B43: Fire exit (keep clear)
- B44: Fire exit (keep clear)
- B45: Fire exit (keep clear)
- B46: Fire exit (keep clear)
- B47: Fire exit (keep clear)
- B48: Fire exit (keep clear)
- B49: Fire exit (keep clear)
- B50: Fire exit (keep clear)
- B51: Fire exit (keep clear)
- B52: Fire exit (keep clear)
- B53: Fire exit (keep clear)
- B54: Fire exit (keep clear)
- B55: Fire exit (keep clear)
- B56: Fire exit (keep clear)
- B57: Fire exit (keep clear)
- B58: Fire exit (keep clear)
- B59: Fire exit (keep clear)
- B60: Fire exit (keep clear)
- B61: Fire exit (keep clear)
- B62: Fire exit (keep clear)
- B63: Fire exit (keep clear)
- B64: Fire exit (keep clear)
- B65: Fire exit (keep clear)
- B66: Fire exit (keep clear)
- B67: Fire exit (keep clear)
- B68: Fire exit (keep clear)
- B69: Fire exit (keep clear)
- B70: Fire exit (keep clear)
- B71: Fire exit (keep clear)
- B72: Fire exit (keep clear)
- B73: Fire exit (keep clear)
- B74: Fire exit (keep clear)
- B75: Fire exit (keep clear)
- B76: Fire exit (keep clear)
- B77: Fire exit (keep clear)
- B78: Fire exit (keep clear)
- B79: Fire exit (keep clear)
- B80: Fire exit (keep clear)
- B81: Fire exit (keep clear)
- B82: Fire exit (keep clear)
- B83: Fire exit (keep clear)
- B84: Fire exit (keep clear)
- B85: Fire exit (keep clear)
- B86: Fire exit (keep clear)
- B87: Fire exit (keep clear)
- B88: Fire exit (keep clear)
- B89: Fire exit (keep clear)
- B90: Fire exit (keep clear)
- B91: Fire exit (keep clear)
- B92: Fire exit (keep clear)
- B93: Fire exit (keep clear)
- B94: Fire exit (keep clear)
- B95: Fire exit (keep clear)
- B96: Fire exit (keep clear)
- B97: Fire exit (keep clear)
- B98: Fire exit (keep clear)
- B99: Fire exit (keep clear)
- B100: Fire exit (keep clear)

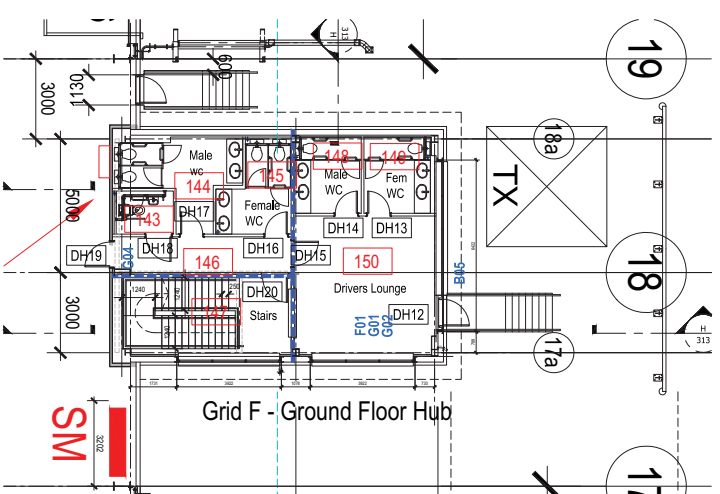
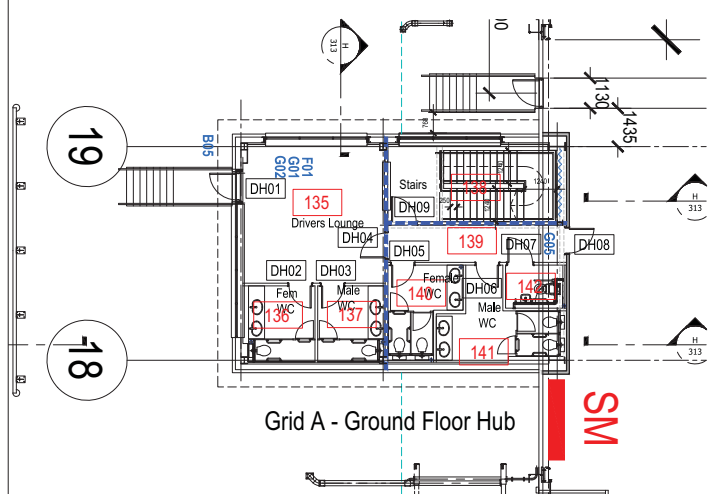
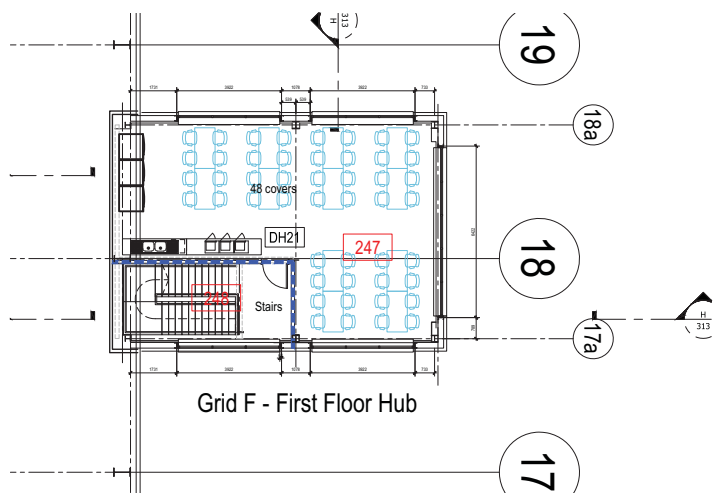
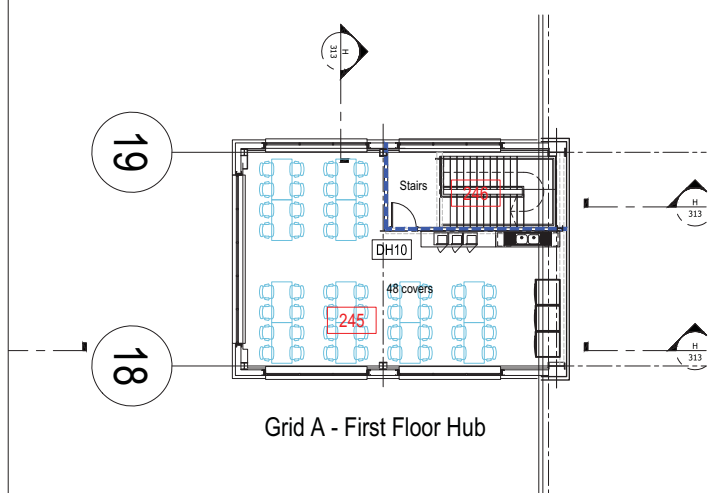
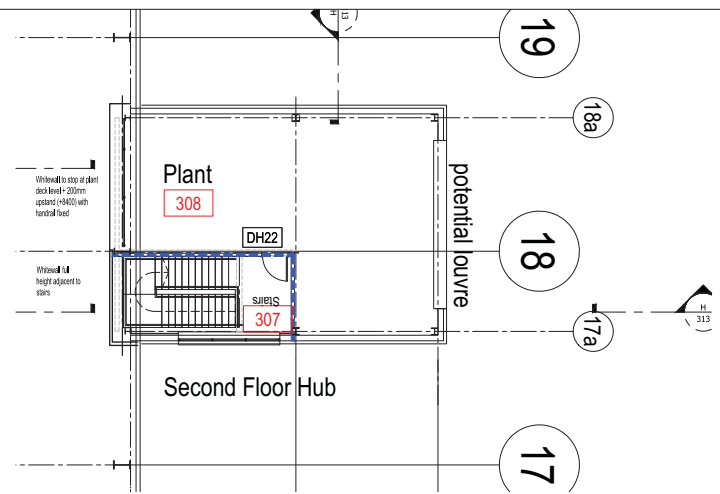
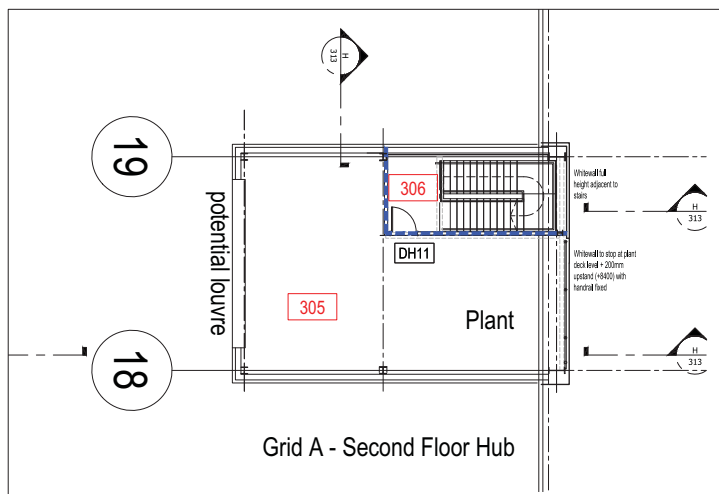

P1 first issue 07oct2016 PL
 P2 hub grid F position finalised 04nov2016 PL
 P3 fire strategy added for comment 22nov2016 PL
 P4 48 covers and tea point to each Hub FFloor 08dec2016 PL
 P5 second floor plant open to unit, stairpods omitted 09jan2017 PL
 P6 Whitewall notes and handrail added to 2nd floor plans 16jan2017 JM

Drawn by: PL Checked by: RM
 Scale of A1: 1/50 Date: oct2016

3726-4-A207 P6
 PLANS - HUB OFFICES, STAIRPODS,



php architects

PROPOSED DEVELOPMENT LAND
BROWNS LANE
COVENTRY



PRELIMINARY

Copyright reserved. Drawings to be checked on site. Discrepancies to be reported before proceeding.